

Android: Motorola (IMAP)

This is a setup guide that will assist you in setting up your Hosted Mailbox on Motorola mobile and tablet devices using IMAP.

1. Locate the "**Settings**" icon within your Apps Drawer.

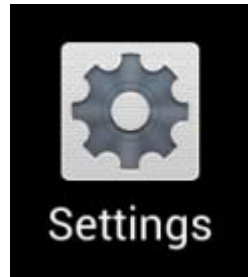

2. Within Settings, scroll down and select "**Add Account**".

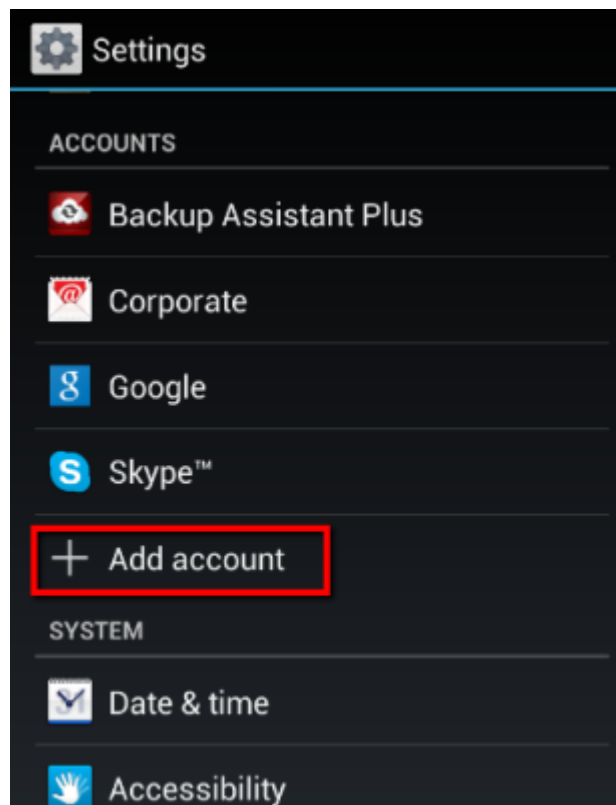

3. Select "**Email**".

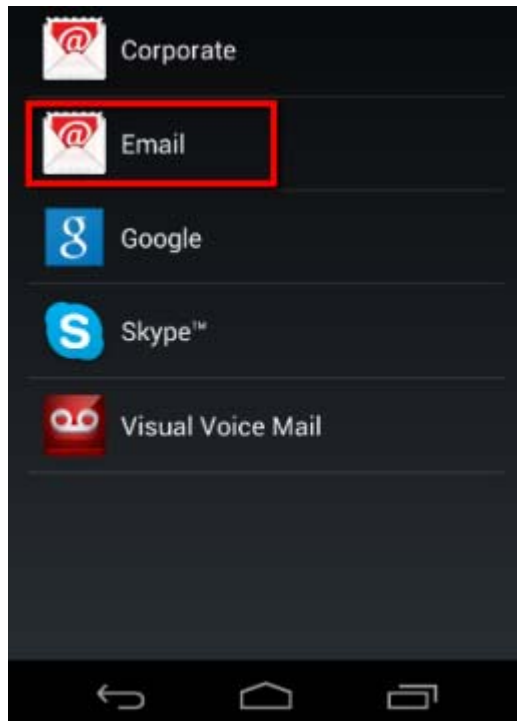

4. Select "Other".

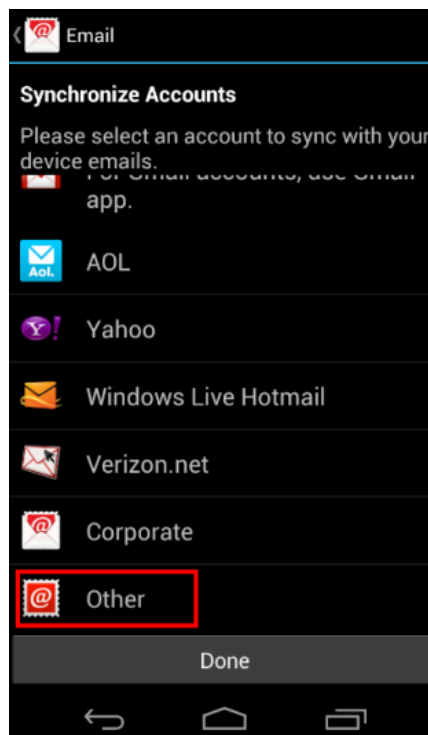

5. Enter the following information:
- "Email Address": **XXXXXX@salishmail.com** (Replace XXXXXX with your mailbox name)
 - "Password": Your email address password

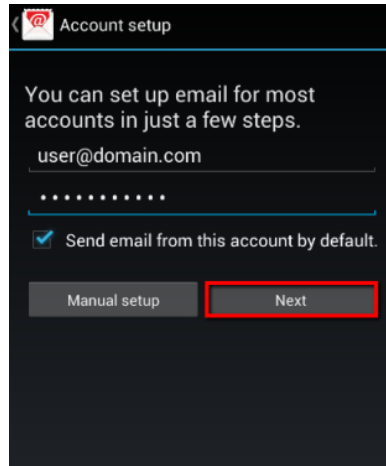

6. Tap "**Next**".
7. Select "**IMAP**" within the Account Setup screen.

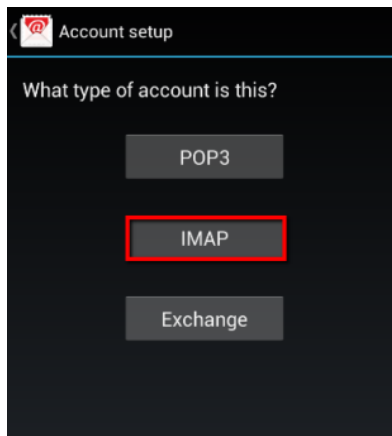

8. Enter the following information:
 - a. "**Username**": **XXXXXX**@salishmail.com (**Should be the same as 5.a. above**)
 - b. "**Password**": Your email address password
 - c. "**IMAP Server**": secure.emailsrvr.com
 - d. "**Port**": 993
 - e. "**Security type**": SSL
 - f. "**Authentication Method**": Auto
 - g. "**IMAP path prefix**": Leave this field blank

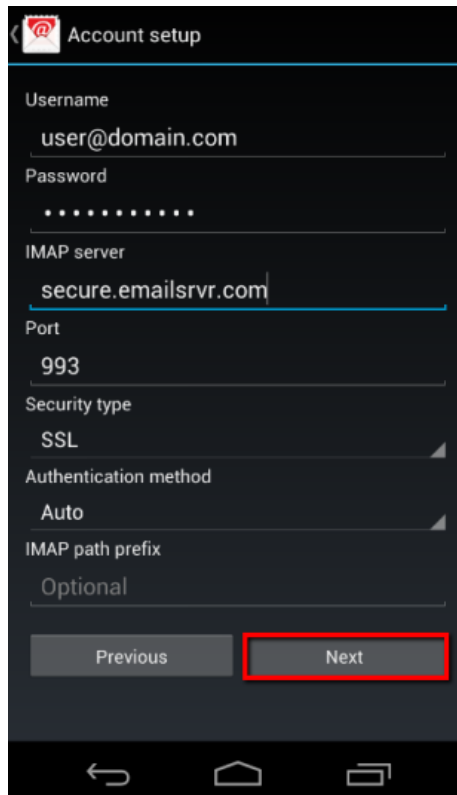

9. Tap "**Next**".
10. Enter the following information:
 - a. "**SMTP server**": secure.emailsrvr.com
 - b. "**Port**": 465
 - c. "**Security type**": SSL/TLS
 - d. "**Require sign-in**": Checked
 - e. "**Authentication method**": Auto
 - f. "**Username**": **XXXXXX**@salishmail.com (**Should be the same as 5.a. above**)
 - g. "**Password**": Your email address password

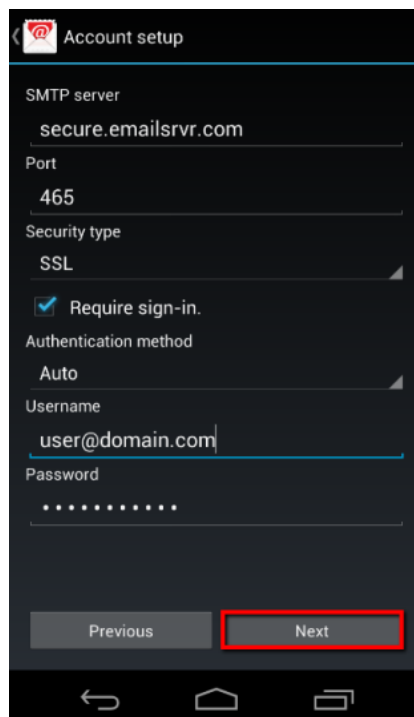

11. Tap "**Next**".
12. Adjust the displayed mailbox settings, if applicable.

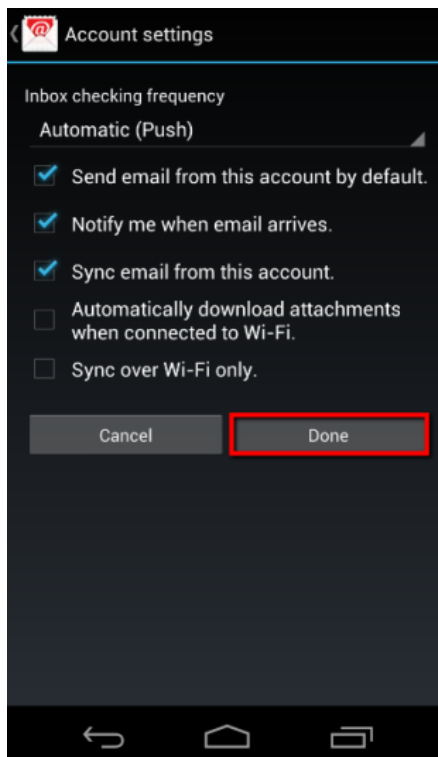

13. Tap "**Done**".
14. Within the "**Account setup**" screen, enter your Email Address and your Name.

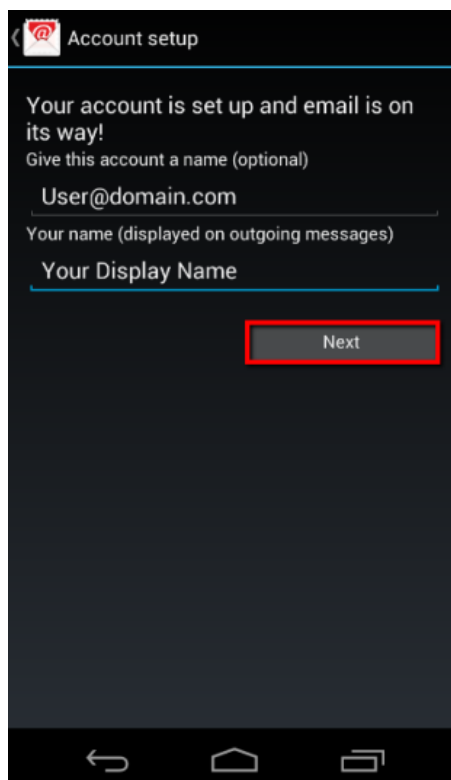

15. Tap "**Next**".
16. Success! Your Motorola device should now begin syncing with your mailbox.